



ON THE ROCKS

A Newsletter of the Michigan Basin Geological Society

2019-2020 Edition 1

www.mbgs.org

September 2019



ANNOUNCEMENTS

“Welcome Fall Annual MBGS BBQ” Membership Meeting, September 11th, 2019: Michigan Basin Geological Society meeting will be hosted at Western Michigan University in the Michigan Geological Repository for Research and Education Building, Kalamazoo, Michigan. A BBQ style dinner will be available for members. Bennie See will present “Oil Patch Then and Now” after dinner. Cost: \$25 members; \$10 students. Social hour - 5:00PM, dinner – 6:00 PM, presentation - 7:00PM. Reservations are requested. Please RSVP to Jennifer Trout at jennifer.l.trout@wmich.edu.

INTRODUCING THE 2019 - 2020 MBGS EXECUTIVE COMMITTEE MEMBERS

- President – Jennifer Trout, Western Michigan University
- Vice President – VACANT
- Secretary – John Yellich, Michigan Geological Survey
- Treasurer – Mike Pozinak, Arcadis
- Business Manager – Peter Rose, Michigan Department of Natural Resources

Michigan Basin Geological Society is in need of a Vice President for the 2019-2020 year. If interested, please contact any one of our executive members.

OTHER NEWS

MBGS HISTORICAL PUBLICATIONS ARE NOW AVAILABLE ON USB FLASH DRIVES (8GB).

LED FIELD LENS AND MBGS LANYARD

The Michigan Basin Geological Society is offering geological field hand lens and lanyards. The field hand lens is a large 21mm lens with a 20X magnification. A pair of white LEDs provides illumination for all those darkened close-up viewing of rocks, minerals and fossils. A case is provided for the field lens with a key to remove the batteries. Batteries are included. The green lanyard has MICHIGAN BASIN GEOLOGICAL SOCIETY printed on one side of the 1" wide webbing. This lanyard is designed with a breakaway buckle clip and detachable keychain for versatile use and comfortable wearing. MBGS is offering the Lanyard/LED Hand Lens and Case combo for \$15 each and the Lanyard alone for \$5 each if picked up at a meeting or field trip. If you request to have your purchase mailed, standard costs for mailing container and postage will apply. Please contact Mark Wollensak at wollensak@att.net to order.





September 2019 MBGS Membership Meeting

When: September 11th, 2019.

Executive committee meeting at 4:30 PM (members welcome)

Social hour - 5:00 PM, dinner – 6:00 PM, presentation - 7:00 PM

Dinner menu: BBQ chicken, ribs, potato salad, baked beans, desert, beverages (water/soda)

Reservations are requested. Please RSVP to Jennifer Trout at jennifer.l.trout@wmich.edu.

Where: Western Michigan University, Michigan Geological Repository for Research and Education, 5272 W. Michigan Avenue, Kalamazoo, MI 49006, (269) 387-8633

Cost: \$25 members; \$10 students

Speaker: Bennie See

Presentation: “Oil Patch Then and Now”

Abstract: Mr. See will discuss 35 years working in the Oil Patch as an exploration geologist, and the changes that he has experienced during this time.

Biography: Bennie See



Retired geologist with thirty-five years oil & gas exploration experience both domestic and foreign. Areas worked include the Gulf of Mexico, Australia, Peru and many other areas including Michigan. Currently studying the sub-surface geology of Jackson and Calhoun Counties in affiliation with Albion College.



MBGS September 2019 Membership Meeting

Directions

Western Michigan University, Michigan Geological Repository for Research and Education, 5272 W. Michigan Avenue, Kalamazoo 49006

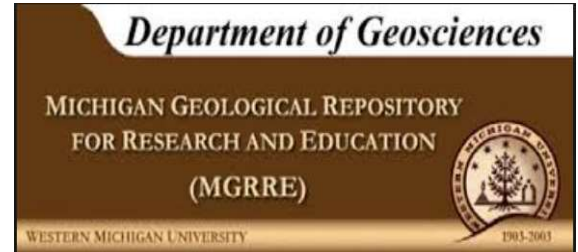

From the Kalamazoo Airport

Exit the airport and turn right onto Portage Road. Go 0.2 miles to I-94
Take I-94 West toward Chicago—go 3.9 miles
Take Exit #74B/US-131 North to I-94-BUS East toward Grand Rapids—go 2.1 miles
I-94-BUS East becomes US-131 North—go 0.4 miles
Take exit #36B onto Stadium Drive toward Oshtemo—go 0.5 miles
Turn right on S. 11th Street—go 0.1 miles
Turn right on W. Michigan Avenue—go 0.3 miles and arrive at 5272 W. Michigan.
Our driveway is the first one just past the US131 overpass on the left, through the fence gates. Our building is the largest one in this fenced area.

From the South or North

From US 131, take exit #36B/Stadium Drive onto Stadium Drive—go 0.4 miles. Turn right on S. 11th Street—go 0.1 miles. Turn right on W. Michigan Avenue—go 0.3 miles and arrive at 5272 W. Michigan Avenue. Our driveway is the first one just past the US131 overpass on the left, through the fence gates. Our building is the largest one in this fenced area.

From the East or West

From I-94, exit onto US 131 North—go about 2.5 miles and take exit #36B onto Stadium Drive toward Oshtemo—go 0.5 miles
Turn right on S. 11th Street—go 0.1 miles
Turn right on W. Michigan Avenue—go 0.3 miles and arrive at 5272 W. Michigan.

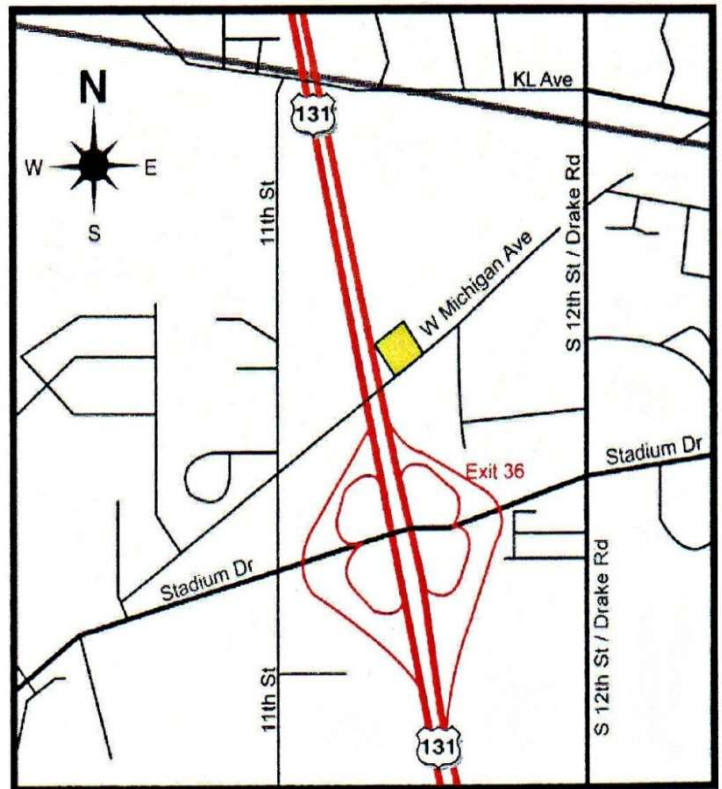

The driveway is the first one just past the US131 overpass on the left, through the fence gates.



EVENTS

September 9th, 2019: Society of Petroleum Engineers, Michigan Section Distinguished Lecturer, Troy, Michigan, <http://spe-michigan.informz.net/spe-michigan/data/images/2019%20September%20MI%20Soc%20Petr%20Engr%20Meeting.pdf>

September 11th, 2019: MBGS Monthly Meeting, Western Michigan University, Speaker Bennie See, “Oil Patch Now and Then”, Kalamazoo, Michigan, www.mbgs.org

September 13-15th, 2019: Rock, Mineral and Jewelry Show, Holland, Michigan <http://www.tulipcity.org/>

September 21-22nd, 2019: Livingston Gem and Mineral Society, Howell, Michigan, <http://www.livingstongems.com/>

September 25th, 2019: EGLE Michigan Petroleum Storage Tanker Conference Series, Gaylord, Michigan, https://www.michigan.gov/egle/0,4561,7-135-3308_3333-491838--,00.html

September 28-29th, 2019: Gem and Mineral Show, Traverse City, Michigan, <http://www.tcrockhounds.com/>

October 5-6th, 2019: Mineralogical & Lapidary Society Rock Swap, Belleville, Michigan <http://www.mmls.us/>

October 9th, 2019: EGLE Michigan Petroleum Storage Tanker Conference Series, Grand Rapids, Michigan, https://www.michigan.gov/egle/0,4561,7-135-3308_3333-491838--,00.html

October 11-13th, 2019: “75th Anniversary” Greater Detroit Gem, Mineral & Fossil Show, Warren, Michigan, https://docs.wixstatic.com/ugd/ceb2d5_9075cba89f7040b0a5bd6a9d1fdb16bf.pdf

October 12-16th, 2019: 48th Annual AAPG Eastern Section Annual Meeting, Columbus, Ohio, <https://www.esaapg.org/annual-meeting/>

October 16-18th, 2019: EGLE Great Lakes Environmental Remediation and Redevelopment Conference, Lansing, Michigan, https://www.michigan.gov/egle/0,9429,7-135-3308_3333-490862--,00.html

October 18-20th, 2019: Central Michigan Gem & Mineral Show, Mason, Michigan, <http://www.michrocks.org/>

October 19-20th, 2019: Flint Rock & Gem Show, Clio, Michigan <http://www.flintrockandgem.org/>

October 23rd, 2019: 2019 Annual MiCorps Conference & Training, Kettunen Center, Tustin, Michigan <https://micorps.net/events/>

October 23rd, 2019: EGLE Michigan Petroleum Storage Tanker Conference Series, Dearborn, Michigan, https://www.michigan.gov/egle/0,4561,7-135-3308_3333-491838--,00.html

November 2-3rd, 2019: Gem and Mineral Show, Midland, Michigan, <http://www.midmichrockclub.com/>

November 11th, 2019: Michigan Mineral Society Auction, Bloomfield Hills, Michigan <http://www.michmin.org/>

November 20-21st, 2019: EGLE Michigan Sustainability Conference, Lansing Center, Lansing, Michigan, https://www.michigan.gov/egle/0,9429,7-135-3308_3333-393527--,00.html

December 11th, 2019: Michigan Section AIPG Meeting, Weber's Inn, Ann Arbor, Michigan, <http://mi.aipg.org/default.htm>

EGLE Calendar of Training and Workshops

https://www.michigan.gov/egle/0,9429,7-135-3308_3333--,00.html

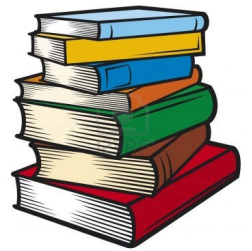

ONLINE RESOURCES

- **Michigan Geology Maps Available:** https://www.michigan.gov/deq/0,4561,7-135-330_00.html
- **Digital Geology Library Overview:** https://www.michigan.gov/documents/deq/GIMDL-Catalog-2010-01-20_307979_7.pdf
- **GeoWebFace:** https://www.michigan.gov/deq/0,4561,7-135-3311_60700--,00.html
- **Digital Geology Library Mining Overview:** https://www.michigan.gov/documents/deq/GIMDL-Catalog-2013_06_22_mining_425595_7.pdf
- **Michigan Geological Survey:** <https://wmich.edu/geologysurvey>
- **USGS Michigan Geological Map Data:** <https://mrdata.usgs.gov/geology/state/state.php?state=MI>
- **CMU, Clarke Historical Library, Michigan Geology:**
https://www.cmich.edu/library/clarke/ResearchResources/Michigan_Material_Statewide/Michigan_Oil_and_Gas_Industry/History_of_Michigan_Oil_and_Gas/Pages/Michigan-Geology.aspx

MICHIGAN BASIN GEOLOGICAL SOCIETY OFFICERS 2019-2020

PRESIDENT: JENNIFER TROUT, Staff Geologist
Michigan Geological Repository for Research and Education
1903 W. Michigan Ave., Kalamazoo, MI 49008-5241
W (269) 387-8633 C (269) 290-4048, jennifer.l.trout@wmich.edu

VICE PRESIDENT: VACANT

SECRETARY: JOHN A. YELlich, Director
Michigan Geological Survey, Western Michigan University
1903 West Michigan Ave, Kalamazoo, MI 49008-5241
W (269) 387-8649 C (303) 901-2886; john.a.yellich@wmich.edu

TREASURER: MIKE POZNIAK, Senior Geologist
Arcadis
300 S. Washington Square, Ste 315, Lansing, MI 48933
W (517) 324-5054 C (517) 898-3839 mike.pozniak@arcadis.com

BUSINESS MANAGER: PETER ROSE, Geologist
Office of Minerals Management, Michigan Department of Natural Resources
W (517) 284-5901, RoseP1@michigan.gov

PAST – PRESIDENT: ADAM W. WYGANT, Director and State Geologist
Michigan Department of Environment, Great Lakes and Energy, Oil, Gas and Minerals Division
W (517) 897-4828, wyganta@michigan.gov

NEWSLETTER EDITOR: ARLENE ANDERSON-VINCENT, Natural Resource Manager
Nestle Waters North America
19275 Eight Mile Road, Stanwood MI 49346
W (231) 823-8451 arlene.anderson-vincent@waters.nestle.com

PUBLICATIONS: JOHN SHOOK, jshook@detroitsalt.com

ELECTRONIC PUBLICATIONS: MARK WOLLENSAK, CPG, wollensak@att.net

WEBMASTER: JOHN ESCH, eschj@michigan.gov

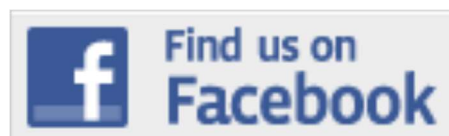

MBGS PUBLICATIONS

<http://www.mbgs.org/publications.html>

Historical publications now available on USB Flash Drives". Each USB Flash Drive is 8GB

Prices include postage, handling and any applicable sales tax.
Orders for publications should be prepaid in U.S. Funds and addressed to:
MBGS — Publications
P.O. Box 14044
Lansing, MI 48901-4044

Historical CD #1: Nine out-of-print publications from 1949 through 1965 and 1998, 2000, \$15

- The Stratigraphy of Manitoulin Island, Ontario, Canada, June 19-20, 1954
- The Devonian and Silurian Rocks of Parts of Ontario, Canada and Western New York, June 22-23, 1951
- The Traverse Group of the Northern Part of the Southern Peninsula of Michigan, June 16-17, 1949
- The Devonian Strata of the London-Sarnia Area, Southwestern Ontario, Compiled by Erwin C. Stumm, Lewis B. Kellum and Jean Davies Wright, June 9-10, 1956
- The Ordovician Rocks of the Escanaba-Stonington Area, Led by R. C. Hussey, June 2-3, 1950
- The Niagara Escarpment of Peninsular Ontario, Canada, June 18-19, 1955
- Lower Paleozoic and Pleistocene Stratigraphy Across Central Wisconsin, Compiled by C. E. Prouty, Led by L. M. Cline, J. L. Hough and R. F. Black, 1960
- Classic Silurian Reefs of the Chicago Area, by Donald G. Mikulic and Joanne Kluessendorf, June 27, 1998
- Geology of Central Ontario, Canada, 1965

Historical CD #2: Four out-of-print publications from 1947, 1959, 1983 and 1991, 2001, \$15

- Copper Country Field Trip, Michigan, June 20-22, 1947
- Geology of Mackinac Island and Lower and Middle Devonian, South of the Straits of Mackinac, June 12-14, 1959
- Tectonics, Structure and Karst in Northern Lower Michigan, August 1983
- Geology of the Pictured Rocks, Upper Peninsula, Michigan, July 11-13, 1991

Historical CD #3: Six out-of-print publications from 1948, 1952, 1990 - 1995, 2001, \$15

- Pleistocene and Early Paleozoic of the Eastern Part of the Northern Peninsula of Michigan, June 18-21, 1948
- Stratigraphy and Structure of the Devonian Rocks in Southeastern MI and Northwestern OH, June 20-21, 1952
- Lower Ordovician and Upper Cambrian of Wisconsin, May 10-12, 1990
- Guidebook to the Precambrian Geology and Metallogeny of the Central Upper Peninsula of Michigan September 12-13, 1991

Historical CD #4: Six out-of-print publications from 1957, 1958, 1961, 1967, 1968 and 1970, 2004, \$15

- Silurian Rocks of the Northern Peninsula of Michigan, 1957
- Cambrian Geology of Parts of Dickinson and Iron Counties, Michigan, June 1958
- Geologic Features of Parts of Houghton, Keweenaw, Baraga and Ontonagon Counties, Michigan, May 19-21, 1961
- Correlation Problems of the Cambrian and Ordovician Outcrops Areas, Northern Peninsula of Michigan 1967
- The Geology of Manitoulin Island, June 1968
- Devonian Strata of Alpena and Presque Isle Counties, Michigan 1970

Historical CD #5: Five out-of-print publications from 1971, 1989, 2001, and Oil & Gas Fields Vol. 1 & 2, 1969 & 1992, 2006, \$50

- Oil & Gas Fields Symposium, Volume 1, April 1969, 200 pp., maps, illus., second printing with updates
- Oil & Gas Fields Manual of the Michigan Basin, Volume 2, 1992, 520 pp., maps, illus.
- Glacial Geology of Southwestern Michigan, 1989, 53 pp. by A. Kehew, L. J. Schmaltz, and W. T. Straw
- Geology of the Lake Erie Islands and Adjacent Shores, 1971, 65pp., maps, illus. by Jane L. Forsyth
- Glacial Geology of Southwestern Michigan, Landforms of the Lake Michigan Lobe, Southwestern Michigan, 2001, AAPG Eastern Section Meeting Field Trip, 32 pp., maps, illus. by A. Kehew and A. Kozlowski

Historical CD #6: Six out-of-print publications from 1946, 1953, 1963, 1966, 1978 & 1987 plus the Richfield Challenge, 1952 & Tom Knapp's MS Thesis, 2007 \$15.

- Guidebook for Ordovician Stratigraphy of the Cincinnati, Ohio and Richmond, Indiana Areas, June 12, 13, 1953 by W. H. Shideler and B. T. Sandefur
- Guidebook for Ontario Geological Excursion to Kettle Point – Owen Sound- Waubesa, June 21, 22, 23 1946 by W. A. Roliff, C.S. Evans and J.F. Caley
- Guidebook for the Stratigraphy of the Silurian Rocks in Western Ohio, May 31-June 2, 1963 by C. H. Summerson, Jane L. Forsyth, Karl V. Hoover and J. R. Ulteig
- Guidebook for Cambrian Stratigraphy in Western Wisconsin, May 21, 22, 1966 by Merideth E. Ostrom
- Geology of the Manitoulin Area, Special Papers #3, September 29, 30 and October 1, 1978 by J. T. Sanford
- and R. E. Mosher
- Middle Devonian Cratonic Carbonates and Shales in Southwestern Ontario, November 14, 1987 by Bruce Wilkinson
- The Richfield Challenge, A Review of the Richfield Developments in Michigan, 1952 by Gordon H. Hautan
- A Theory of Rogers City and Dundee Relationships in Central Michigan, Masters Thesis, 1947 by Tom Knapp

Historical CD #7: Field Guidebooks from 1962, 1969, 1977, 1980, 1985 & 1988, \$15

- Silurian Rocks of the Southern Lake Michigan Area, 1962, James H. Fisher, Chairman, MBGS Annual Field Conference
- Studies of the Precambrian of the Michigan Basin, by Harold B. Stonehouse, 1969
- The Geology of the Marquette District: a Field Guide By F. W. Cambray, 1977
- Ordovician and Silurian Geology of the N. Peninsula of Michigan, 1980, R.B. Votaw, 40 pp., illus., maps
- Special Paper #4: Ordovician and Silurian Rocks of the Michigan Basin and its Margins, 1985 K.R. Cercone and J.M. Budai (eds.), 96 pp., illus.
- Upper Keweenaw Rift-Fill Sequence, Mid-Continent Rift System, Michigan, 1988, P.A. Daniels and R.D. Elmore, M.S. Wollensak, ed., 150 pp., illus., maps

OTHER SPECIAL OFFERS

- **Historical CD Set - # 1 – 7 (detailed above) for a special purchase price of \$95**
- **NE Lower Peninsula Geological Field Conf., 2004, T. Black, M. Wollensak, On CD \$10**
- **Stratigraphic Lexicon for Michigan, 2001, prepared by MBGS and published by DEQ, \$4**
- **Robert E. Mosher Geological Studies** A lifetime of geological research on Silurian Rocks with John T. Sanford. The disks are organized chronologically and include field work in North America and Europe. 2007, 2 CDs \$35.



**REGISTRATION
NOW OPEN**
Early Registration Ends Sept. 30

Alex Epstein , Author
The Moral Case for Fossil Fuels
All-Convention Luncheon

John Jordan, President
AAPG Division of Professional Affairs
DPA Luncheon

Robust Technical Program
(100+ oral and poster presentations)
See website for program & abstracts
3 Field Trips
2 Short Courses
Student Expo

AAPG EASTERN SECTION MEETING HOSTED BY THE OHIO GEOLOGICAL SOCIETY

COLUMBUS, OHIO

ENERGY FROM THE HEARTLAND

OCTOBER 12-16, 2019



Join Us in the Fall
DoubleTree by Hilton Hotel
Columbus-Worthington
\$109 meeting room rate

Sign Up Now to Sponsor / Exhibit !

AAPG Eastern Section Meeting
October 12 – 16, 2019
www.esaapg.org/annual-meeting/